

# FRONT FENDER PANEL REMOVAL/INSTALLATION

B3E091052110W01

1. Disconnect the negative battery cable.

2. Remove the following parts:

- (1) Windshield wiper arm and blade (See [WINDSHIELD WIPER ARM AND BLADE REMOVAL/INSTALLATION.](#))
- (2) Cowl grille (See [COWL GRILLE REMOVAL/INSTALLATION.](#))
- (3) Front side turn lights (See [FRONT SIDE TURN LIGHT REMOVAL/INSTALLATION.](#))
- (4) Front bumper (See [FRONT BUMPER REMOVAL/INSTALLATION.](#))
- (5) Front combination lights (See [FRONT COMBINATION LIGHT REMOVAL/INSTALLATION.](#))
- (6) Side step molding (Vehicle with the side step molding) (See [SIDE STEP MOLDING REMOVAL/INSTALLATION.](#))

3. Remove in the order indicated in the table.

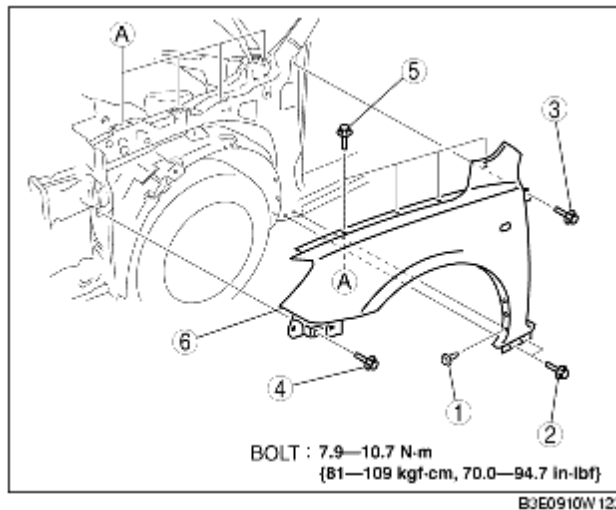

1	Fastener
2	Bolt A
3	Bolt B
4	Bolt C
5	Bolt D
6	Front fender panel

4. Install in the reverse order of removal.